

What's Included

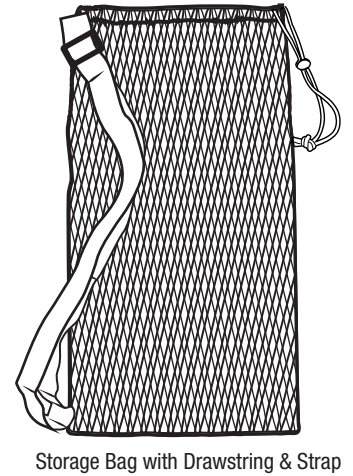

Assembly Roof Rake Head Unit

- 1** Slide **TOP** pole through the pole insert on head unit.

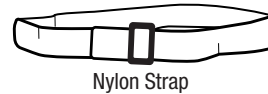
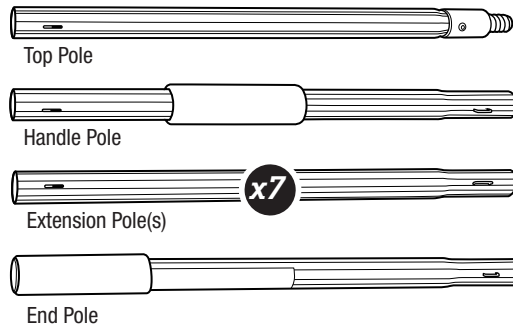
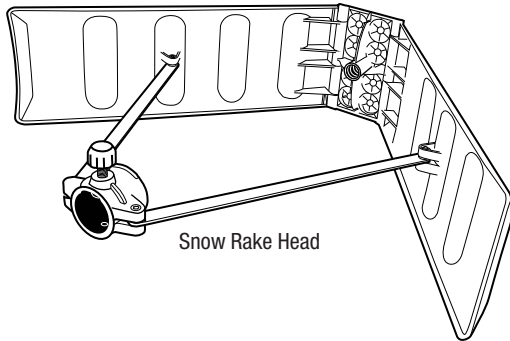
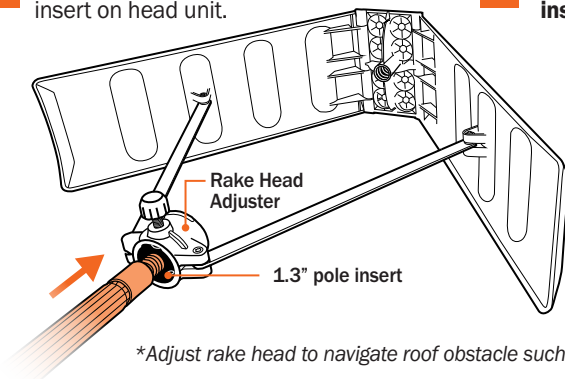

- 2** While keeping the holes aligned, insert **TOP** pole into head unit.

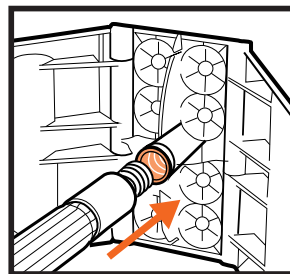

- 3** Turn **TOP** pole **CLOCKWISE** to secure.

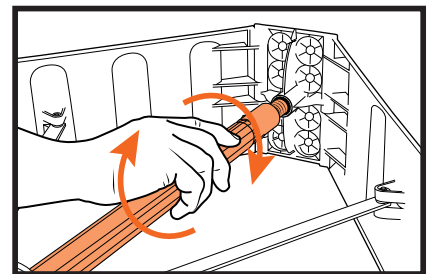

*Adjust rake head to navigate roof obstacle such as roof vents, pipe jacks, turtle vents and valleys.

- 4** Slide **Rake head adjuster** to desired roof rake position.

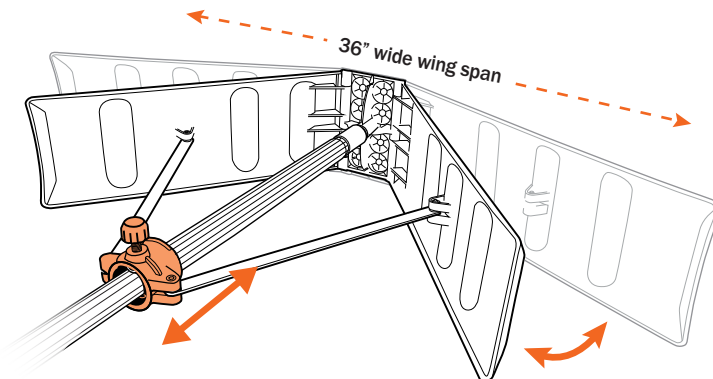

- 5** Hand-tighten* **Rake head adjuster knob** to secure rake position.

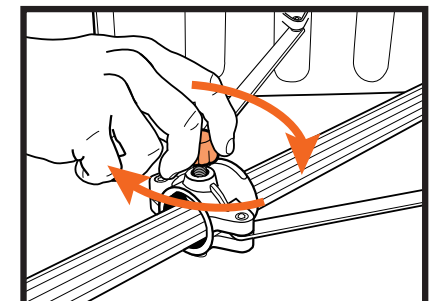

DO NOT USE PLIERS OR OVER-TIGHTEN THE THUMB SCREW

Attaching An Extension Pole

- 1** Press **DOWN** on snap pin and insert into larger end of pole.

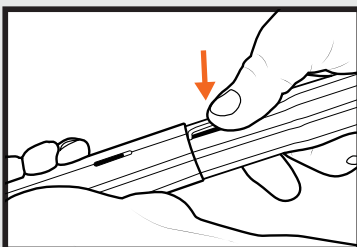

- 2** Align top section of poles until **snap pin engages** in hole.

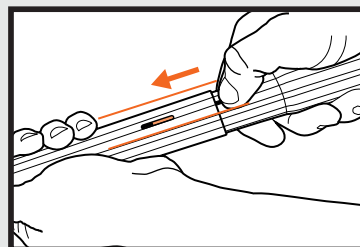

- 3** Continue pushing until **snap pin** locks into place.

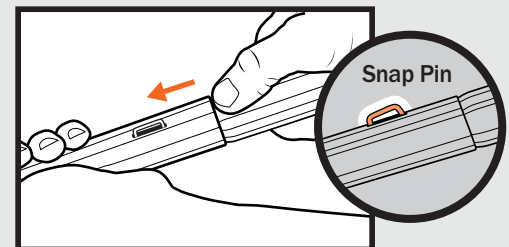

*To disassemble, push snap pin down & pull.

Pole/Extensions Assembly 16 feet (21 feet reach)



Operation

Snow Removal Tips

Step-by-Step Instructions:

- 1

Wait for the Right Conditions
 - Only rake fresh or soft snow if possible. Hardened snow or ice is more difficult and dangerous to remove.
 - Avoid raking in high winds or during icy rain.
 - Make sure visibility is good.
- 2

Stand on Solid, Safe Ground
 - Stay on the ground whenever possible.
 - Do not climb on the roof, may damage shingles.
 - Clear a safe working area around the home. Watch for icy patches, buried obstacles, or uneven ground.
- 3

Start from the Edge of the Roof
 - Begin at the roof's edge (eaves/gutters) and work your way upward, pulling snow downward toward you.
 - Do not push snow up the roof – this can damage shingles.

TIP: Remove snow in small sections (1-2 foot increments) rather than large swaths to maintain control.
- 4

Use Smooth, Controlled Pulls
 - Use slow, steady movements. Avoid jerking or yanking the rake, this can damage shingles.
 - Let gravity help. The snow should fall naturally with each pull.

BE CAREFUL: Don't stand directly under the area you're raking, snow or ice chunks can fall suddenly.

- What You'll Need:
- EZ Smart snow roof rake (has non-abrasive blade to protect shingles)
 - Non-slip boots and winter gloves (not included)
 - Eye protection (not included), since snow chunks can fall suddenly

- 5

Avoid Key Roof Features

These areas can be damaged easily or catch your rake. Stay clear of the following: ***Skylights, Roof vents, Solar panels, Chimneys***
- 6

Don't Try to Clear It All
 - You don't need to remove every bit of snow, just enough to reduce load and prevent ice dams.
 - A general guideline: remove about 6-8+ feet (or more with heavy snow falls) up from the eaves.
- 7

Take Breaks & Stay Safe
 - Snow raking is physical work, take breaks to avoid fatigue.
 - If you feel strain or your pole is iced over, stop and reassess.

SAFETY TIPS

USE A ROOF RAKE PROACTIVELY AFTER EVERY HEAVY SNOWFALL (6 inches or more) to prevent buildup rather than waiting until problems arise.

- Be aware of overhead power lines.
- Never use metal tools that can damage your roof or conduct electricity.
- Don't use a ladder unless absolutely necessary and you have someone to stabilize it.
- If snow is hard-packed or there's ice buildup, consider hiring a professional instead of forcing it.

 **CAUTION: KEEP AWAY FROM ELECTRICAL WIRES**

Convenient Compact Storage

TOPVIEW

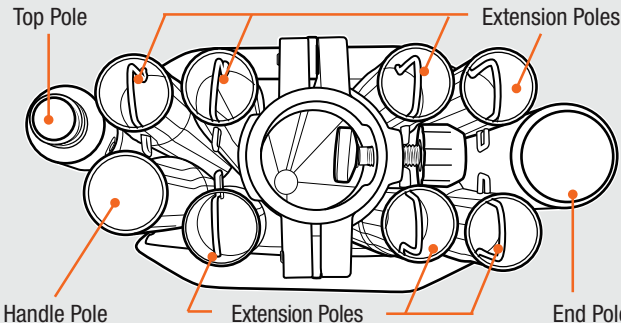

1

Fold roof rake head, then place down with rake adjuster facing up.

2

Place extension poles on the circular receptacles on the roof rake head.

3

Use hook & loop strap to secure poles and folded rake head unit.

4

Place inside mesh carry bag and pull drawstring to close.

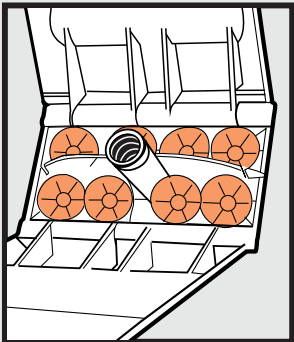

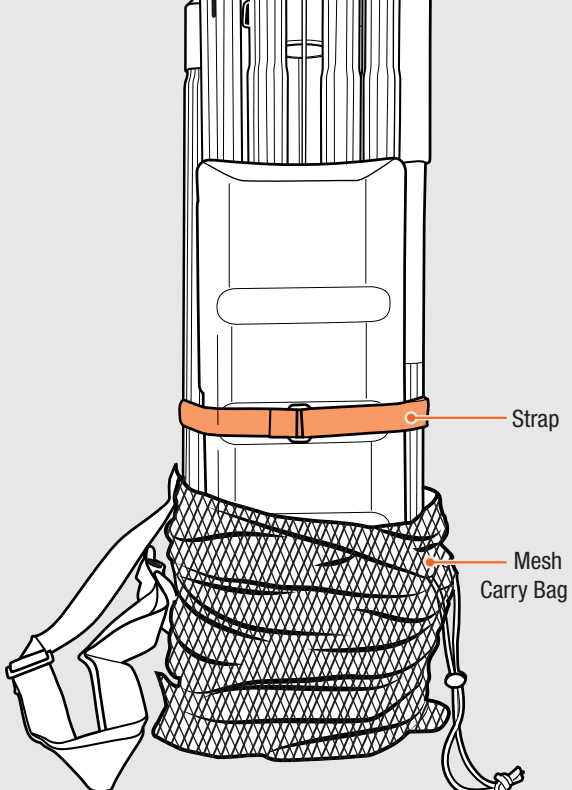

Reach up to 30ft with additional **ADD-A-POLES** (sold separately)

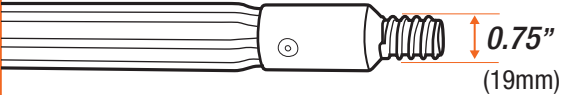

Extension poles work with standard Acme thread products

